

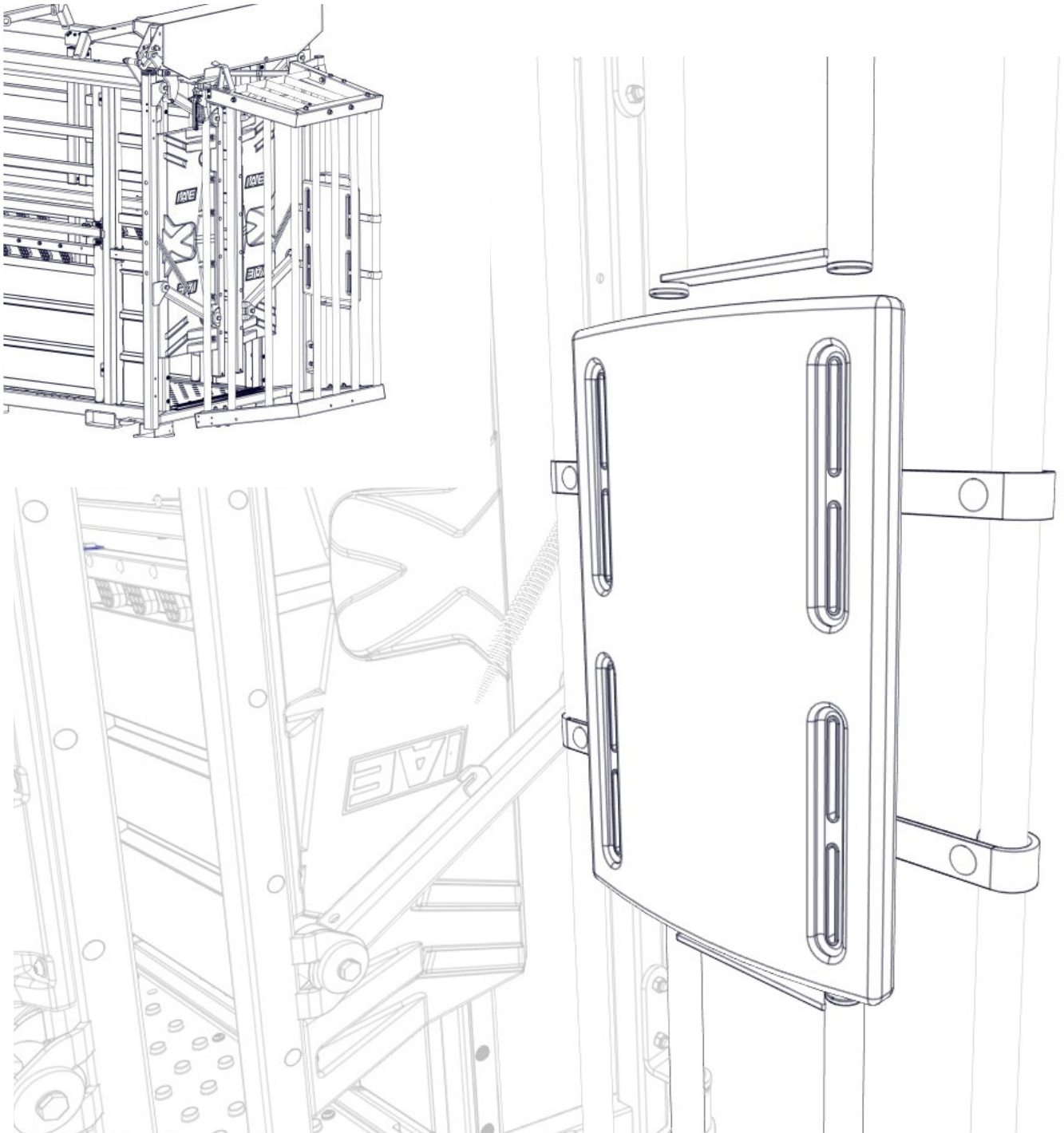

Call: +44 (0)1782 339320 | Email: sales@iae.co.uk | Weblink: <https://iae.co.uk/>



M800 CAGE ID READER KIT

INSTALLATION, OPERATION & MAINTENANCE

TECHNICAL DOCUMENT NO. 1003600-01

INTENDED USE

The kit is associated with the id reader unit when it is integrated into the manual yoke front cage (option to fit), to be mounted to the side of the cage.

before fitting the clamp brackets to attach the antenna panel to the framework of the front cage a minor conversion is required to replace the full height bolt on side panel with two half panels...leaving space in between to position the clamp bars and antenna panel (midway).

TECHNICAL DATA

Item Number: 1003655-01

Load: 1000 Kg Max.

Weight: 8 Kg *(not including the crush or the antenna panel itself)*

COMPATIBLE WITH IAE CRUSHES

- ✓ M800 FULL ACCESS CRUSH - 1002396-01
- ✓ M800 SQUEEZE CRUSH - 1002398-01

(M800 crushes fitted with option to fit FRONT CAGE - 1003642-01)

TOOLS REQUIRED FOR ASSEMBLY

Adjustable wrench / spanner set

SAFETY INFORMATION

PLEASE TAKE NOTE OF THE FOLLOWING SAFETY PRECAUTIONS BEFORE USE FOR THE WELLBEING OF ALL ANIMALS AND PERSONNEL. ANY HARM OR INJURY WHICH OCCURS FROM THE LACK OF COMPLIANCE WITH THESE HEALTH AND SAFETY MEASURES WILL BE THE RESPONSIBILITY OF THE OPERATOR.

- ❑ **IMPORTANT!** Read these instructions carefully before use and keep them for future reference. The safety of your animals may be affected if you do not follow these instructions in this manual.
- ❑ **WARNING! DANGER TO LIFE AND RISK OF ACCIDENTS FOR INFANTS AND CHILDREN!** Keep children away from the product when in operation.
- ❑ Situate this product on a level, solid surface.
- ❑ **WARNING!** Be careful with hands, fingers and limbs when operating the crush.
- ❑ Personal protection may be required for some stages of installation, and/or operation.
- ❑ **CAUTION!** When handling heavy equipment, some stages of installation may require at least two people.
- ❑ **DO NOT** lean on or exert undue pressure on the product.
- ❑ **CAUTION!** Check posture when lifting/manoeuvring the equipment or associated parts.
- ❑ **ALWAYS** Check the product for damage before each use.
- ❑ **NEVER USE THE PRODUCT IF IT IS DAMAGED.**

If you have any questions or comments regarding the product, we will be glad to hear them either through our website www.iae.co.uk or by contacting your local IAE dealership.

INTRODUCTION.....

INTENDED USEPage 2

TECHNICAL DATA.....Page 2

COMPATIBLE WITH IAE CRUSHES.....Page 2

SAFETY INFORMATION.....Page 3

PRODUCT PARTS LISTPage 5

ASSEMBLYPage 6

RECOMMENDED MAINTENANCE.....Page 8

CONTACT.....Page 8

PRODUCT 1003655-01



PARTS LIST

NOTE: ANTENNA PANEL NOT INCLUDED

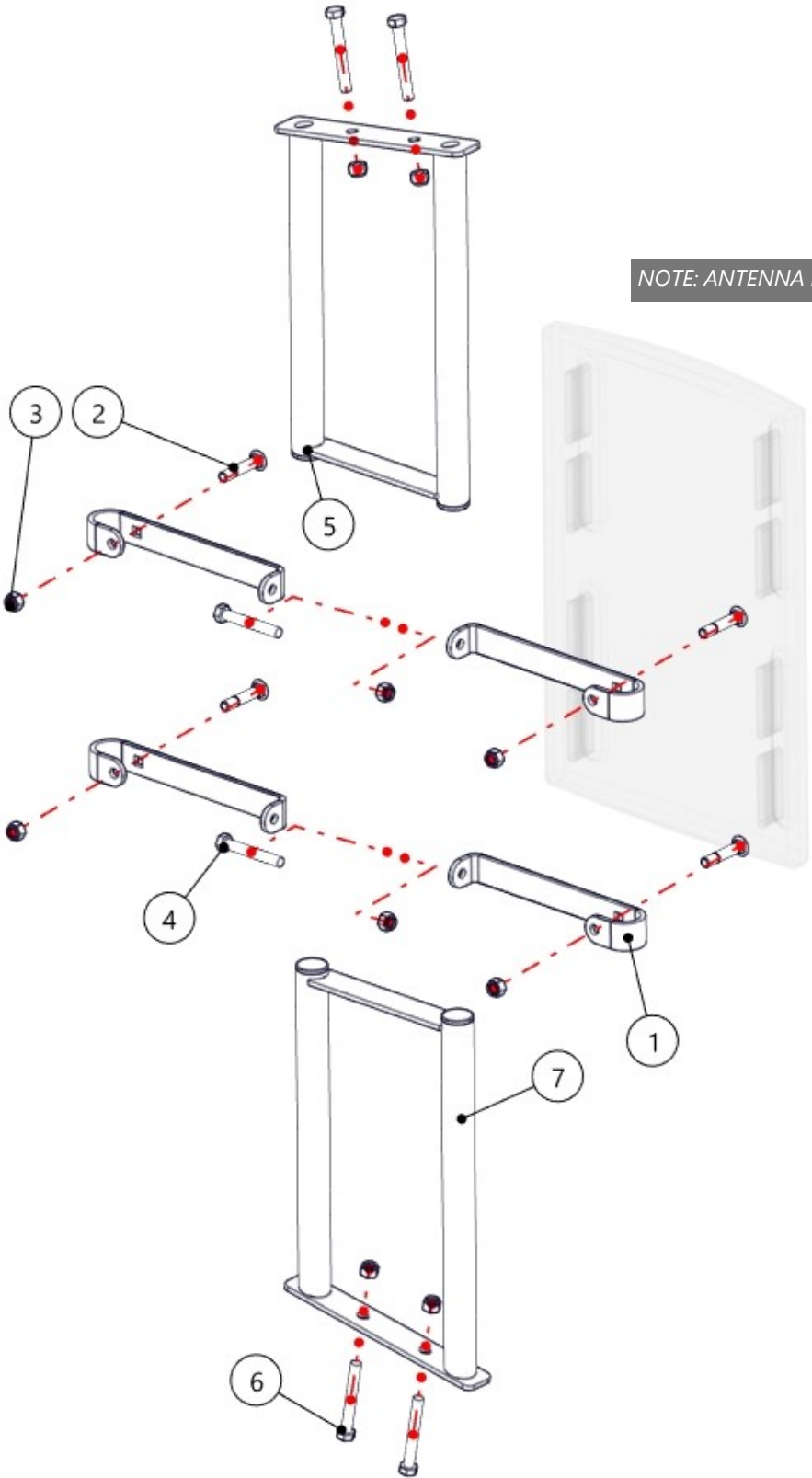

ID	DESCRIPTION	PRODUCT	Qty
1	CLAMP BRACKETS	1002296-01	4
2	M12X65 CUP SQ BOLT	B009 2120 65	4
3	M12 NYLOC NUT	B040 3002 12	10
4	M12X85 BOLT	B003 3120 85	2
5	38.1X2.5-4 WALL BLUE PLASTIC CAP	1002602-01	4
6	M12X95 BOLT	B003 3120 95	4
7	800 SERIES(B21) M800 IDR SIDE PANEL	1002297-01	2
8	300MM BLACK PLASTIC CABLE TIES	B402 0003 00	4

CABLE TIES NOT DEPICTED

ASSEMBLY

- 1 To start, remove the full height bolt-on panel from the front cage.

Note M800 crush body hidden for clarity

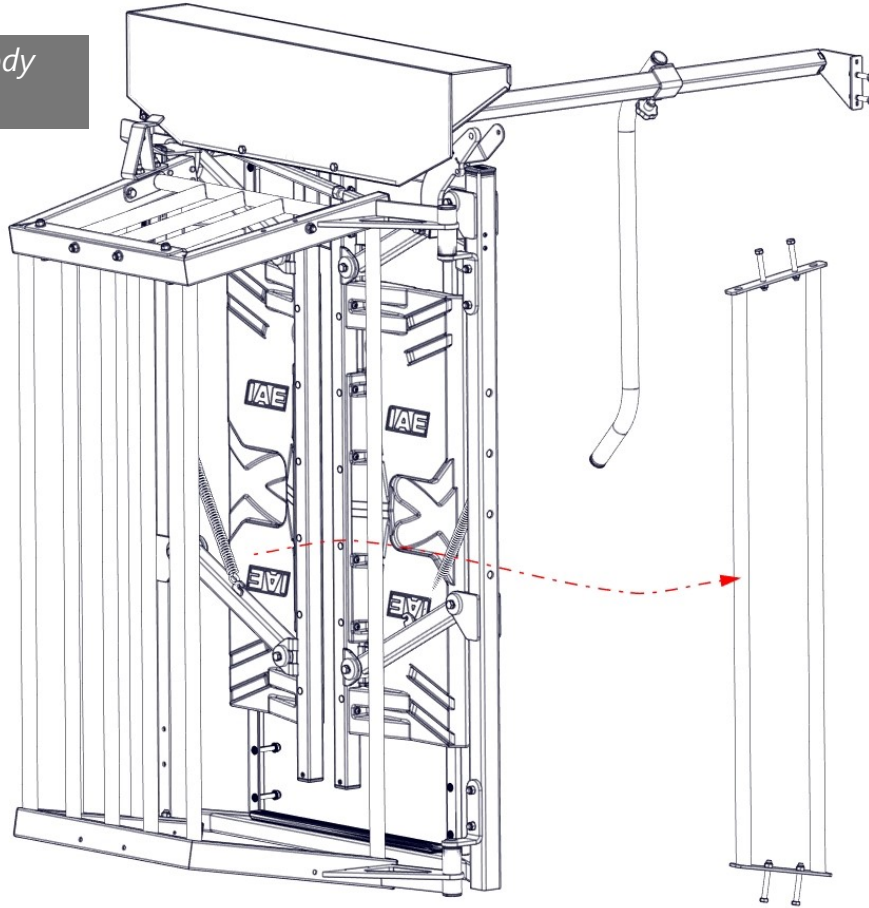

- 2 Replace with half side panels, both upper and lower using corresponding fitting holes.

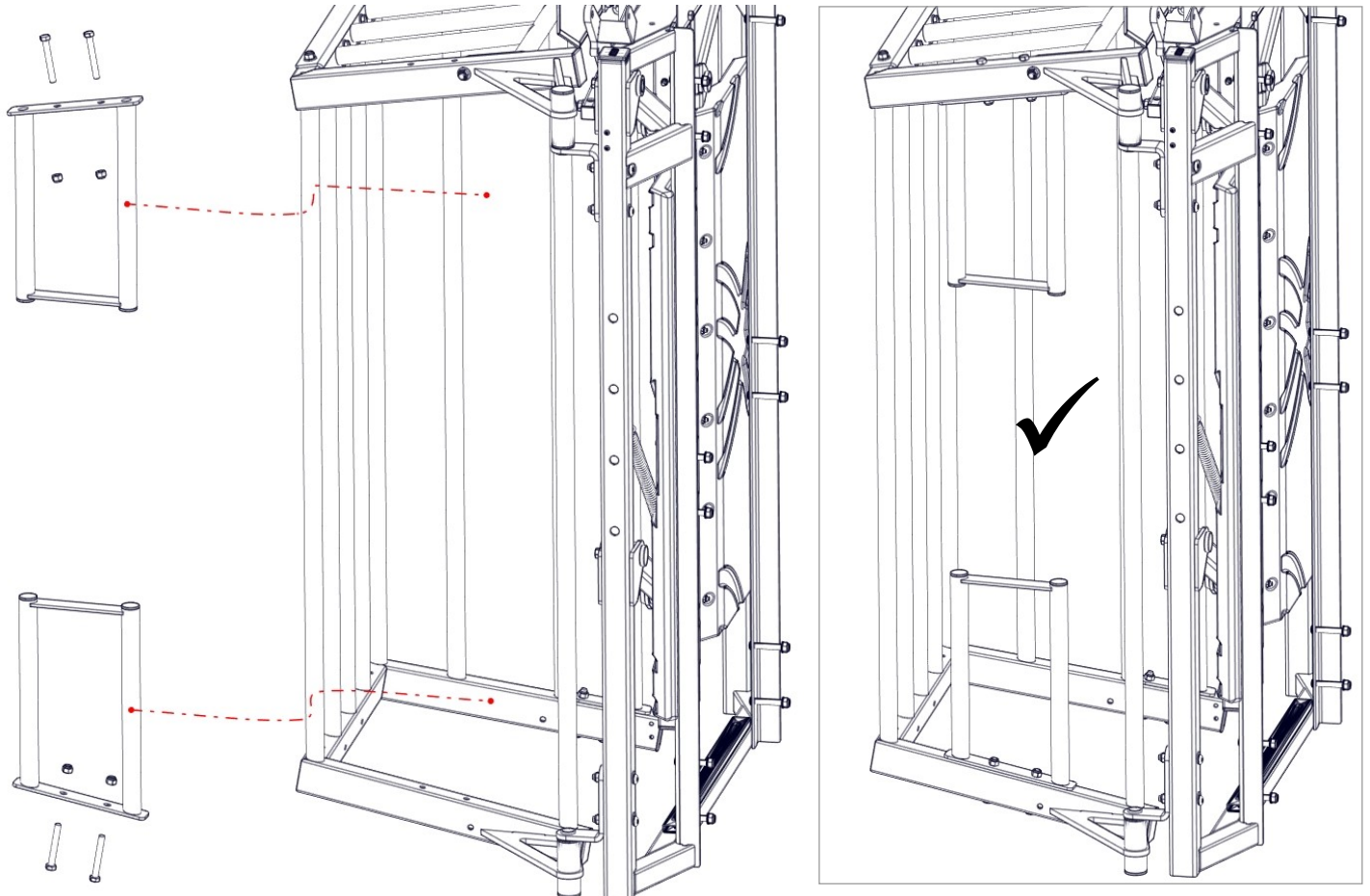

3 Fasten clamp brackets midway, do not fully tighten to allow for adjustment.

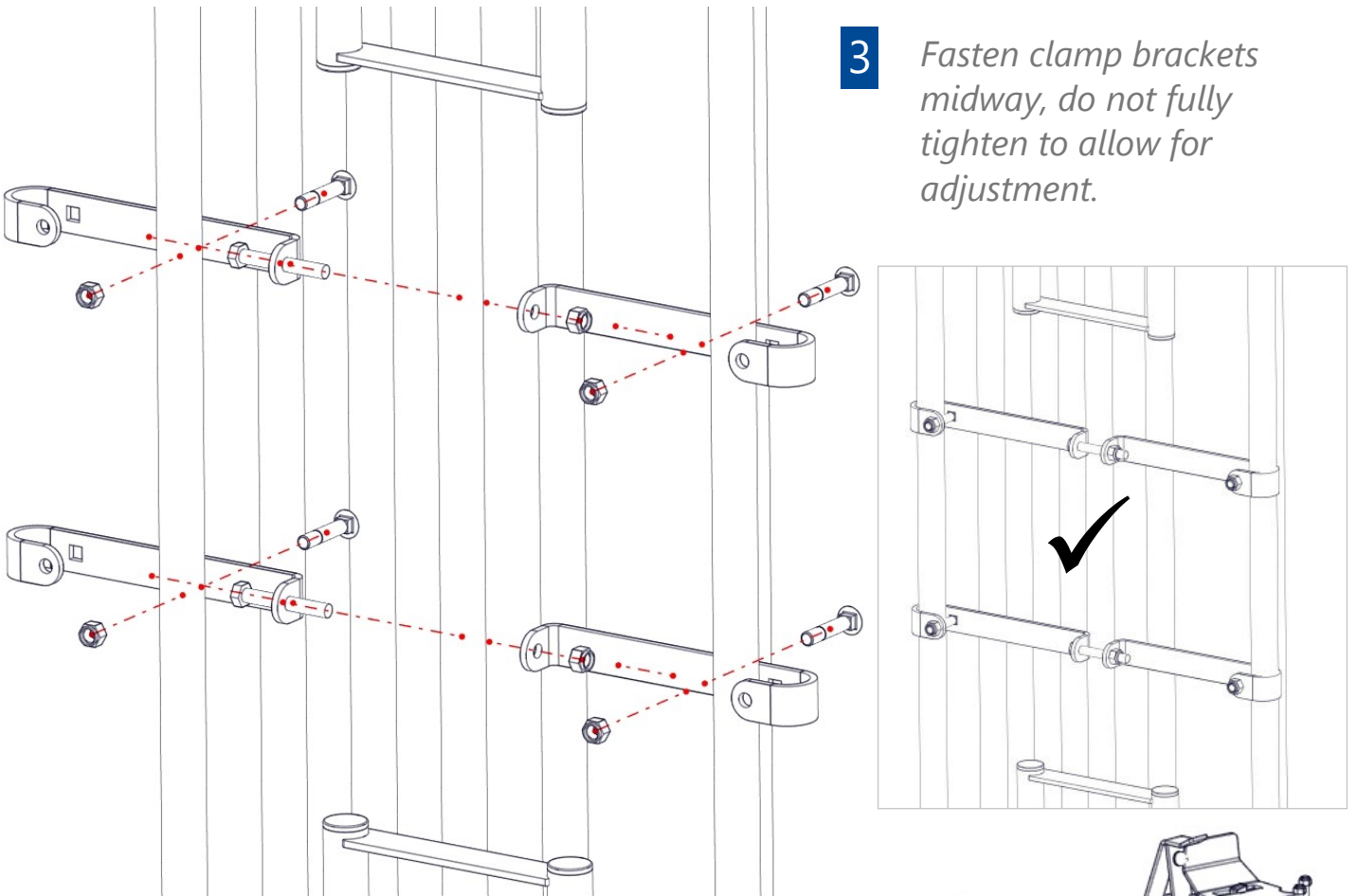

4 Offer the antenna panel up to the clamp brackets, from the inside of the cage, check the positioning of the clamps and adjust to suit ...

Fasten antenna panel to clamp brackets using cable ties (x4) to complete assembly (see below)

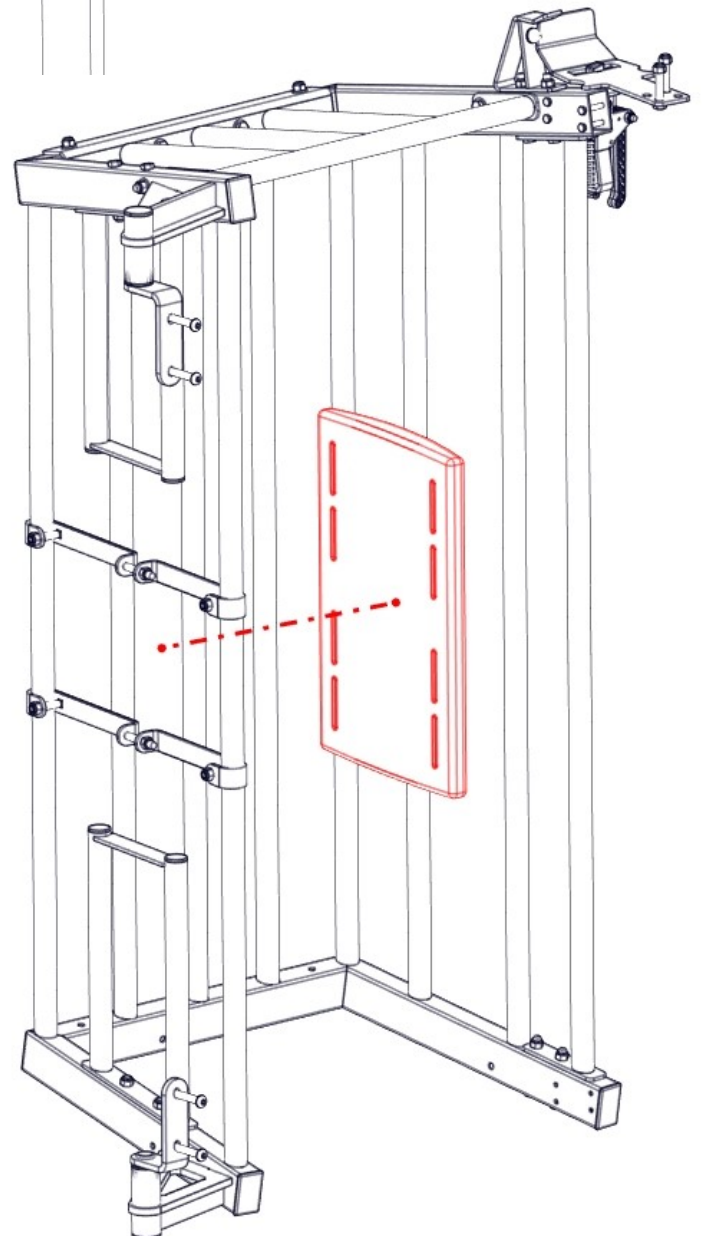
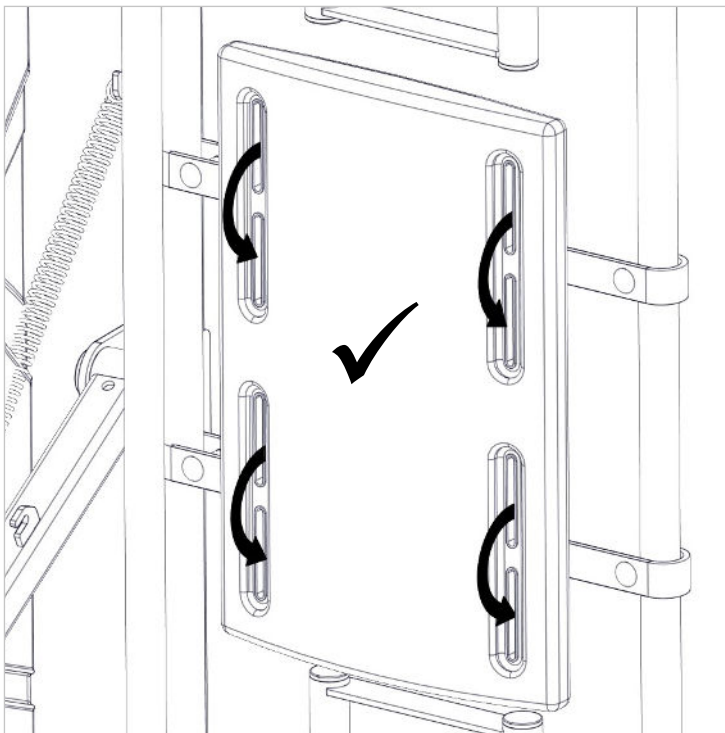

RECOMMENDED MAINTENANCE

REGULAR MAINTENANCE CHECKS TO THE PRODUCT WILL GIVE EARLY WARNING OF ANY PROBLEMS, SUCH AS DAMAGE, CORROSION OR MISSING PARTS...THIS WILL ENSURE YOUR PRODUCT IS RUNNING SMOOTHLY AND SAFELY.

- General inspection of the entire product.
- Ensure all moving components are free of debris and are functioning correctly.
- Any damage to steelwork (causing exposure of bare metal) should be made good by rubbing down and applying x1 coat of galvanizing coating and x1 of oil based paint.
- Check all fasteners sets are tight. Ensure all parts are in place before each use.
- Remove any obstructions
- Simply cleaning down after each use will increase the working life due to the highly corrosive effect of animals urine and/or faeces.

CONTACT

IAE HEADQUARTERS
Mossfield Road
Adderley Green
Stoke-on-Trent
England
ST3 5BW

T: +44 (0)1782 339320

F: +44 (0)1782 339321

E: sales@iae.co.uk

Company Reg number: 01448116 Company VAT number: 319060967

TECHNICAL DOCUMENT NO. 1003600-01